

VISTA EN PLANTA
ESCALA 1:75

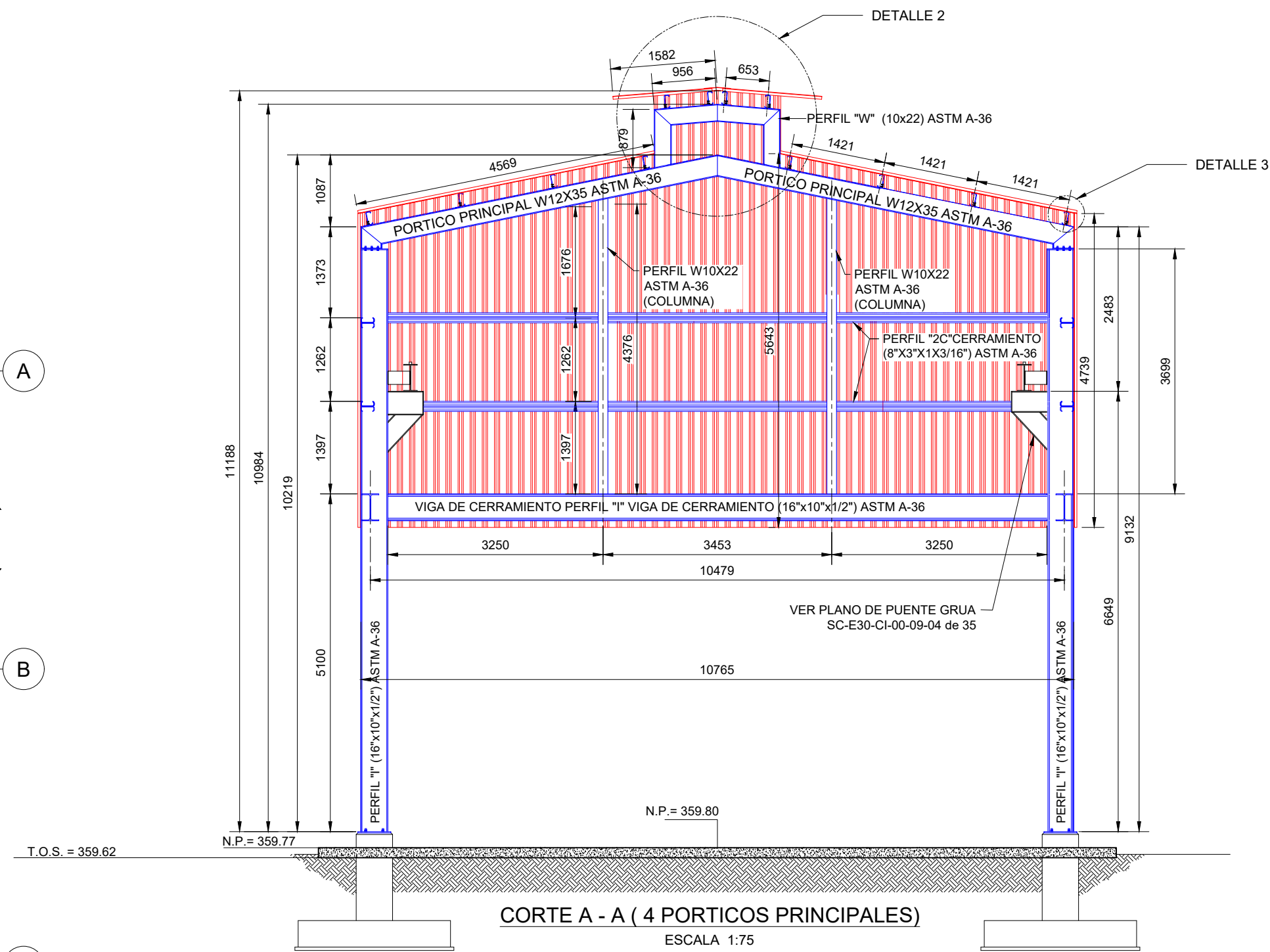

CORTE A - A (4 PORTICOS PRINCIPALES)
ESCALA 1:75

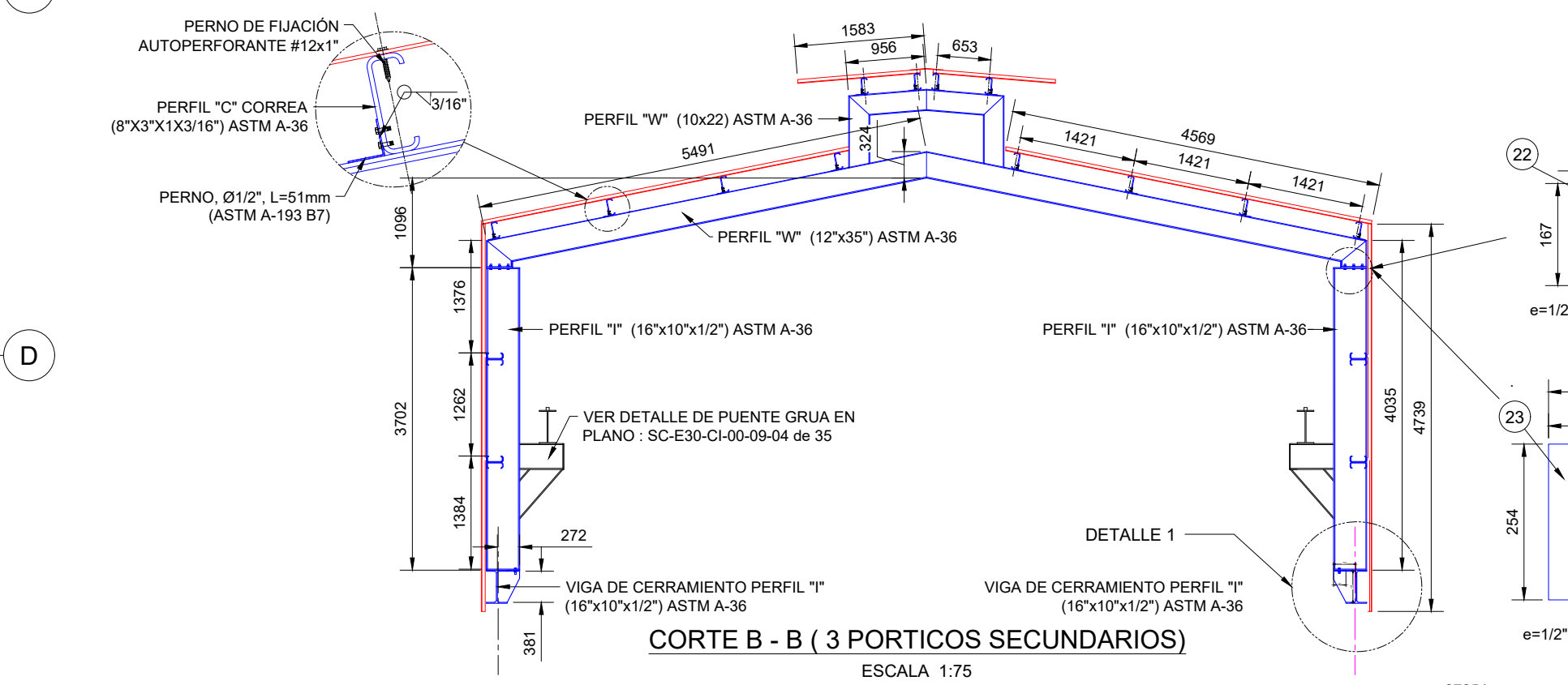

CORTE B - B (3 PORTICOS SECUNDARIOS)
ESCALA 1:75

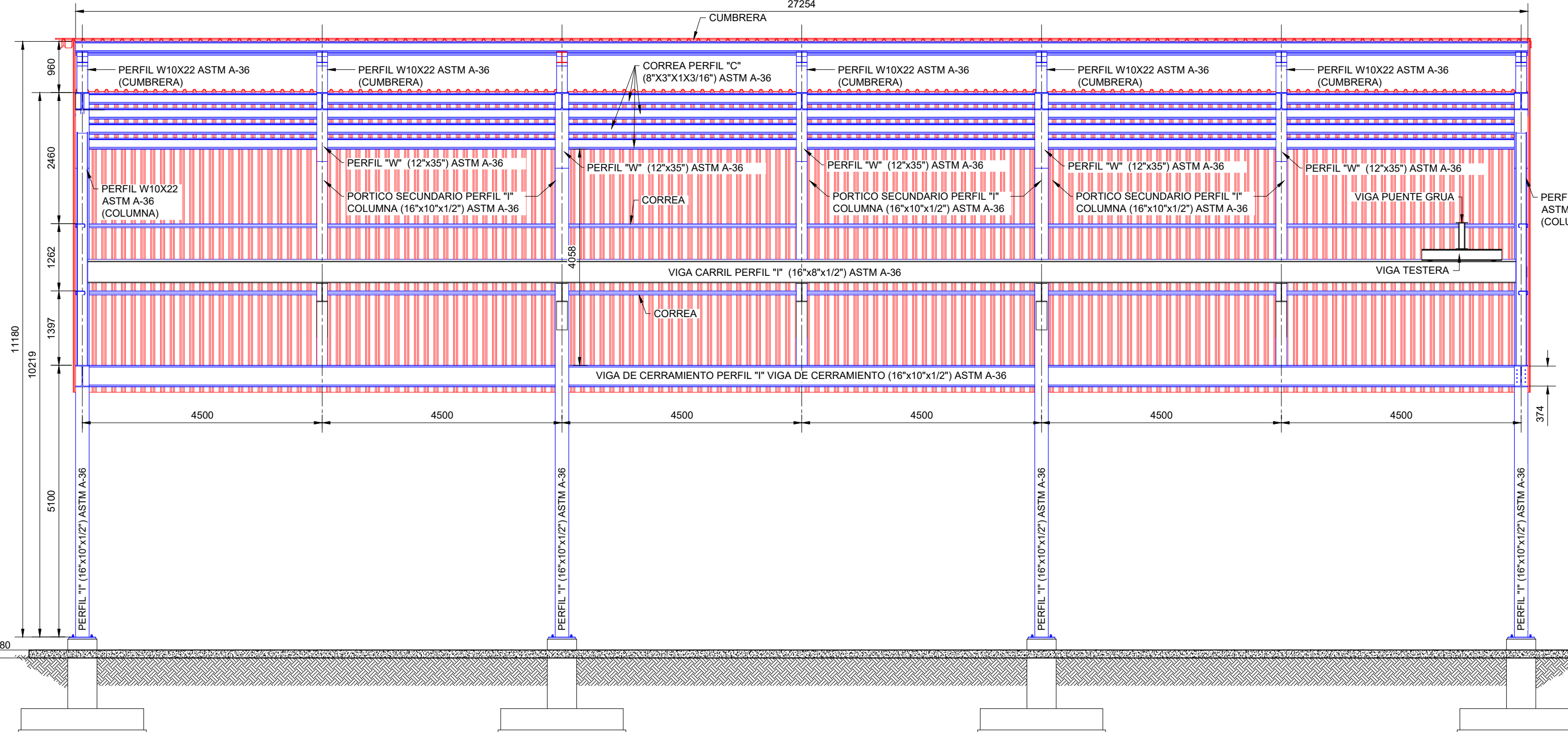

CORTE C - C
ESCALA 1:75

DETALLE 3
S/E

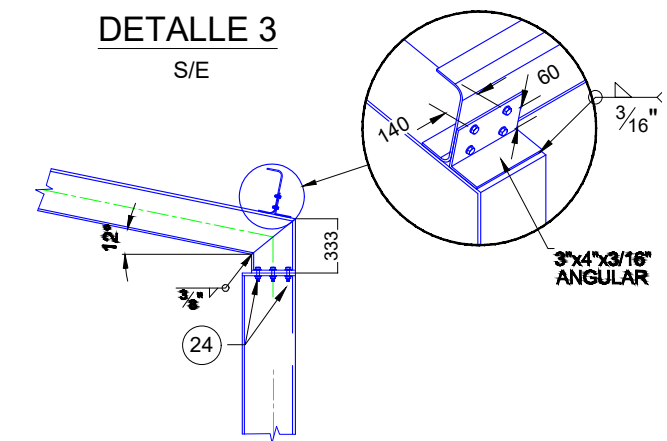

DETALLE 1
S/E

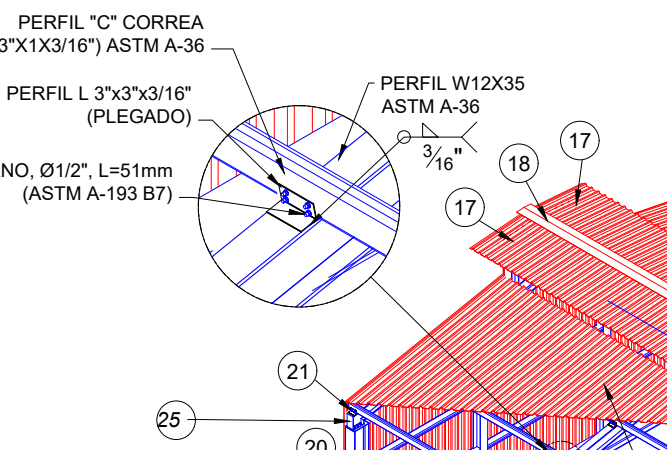

VISTA ISOMETRICA
SIN ESCALA

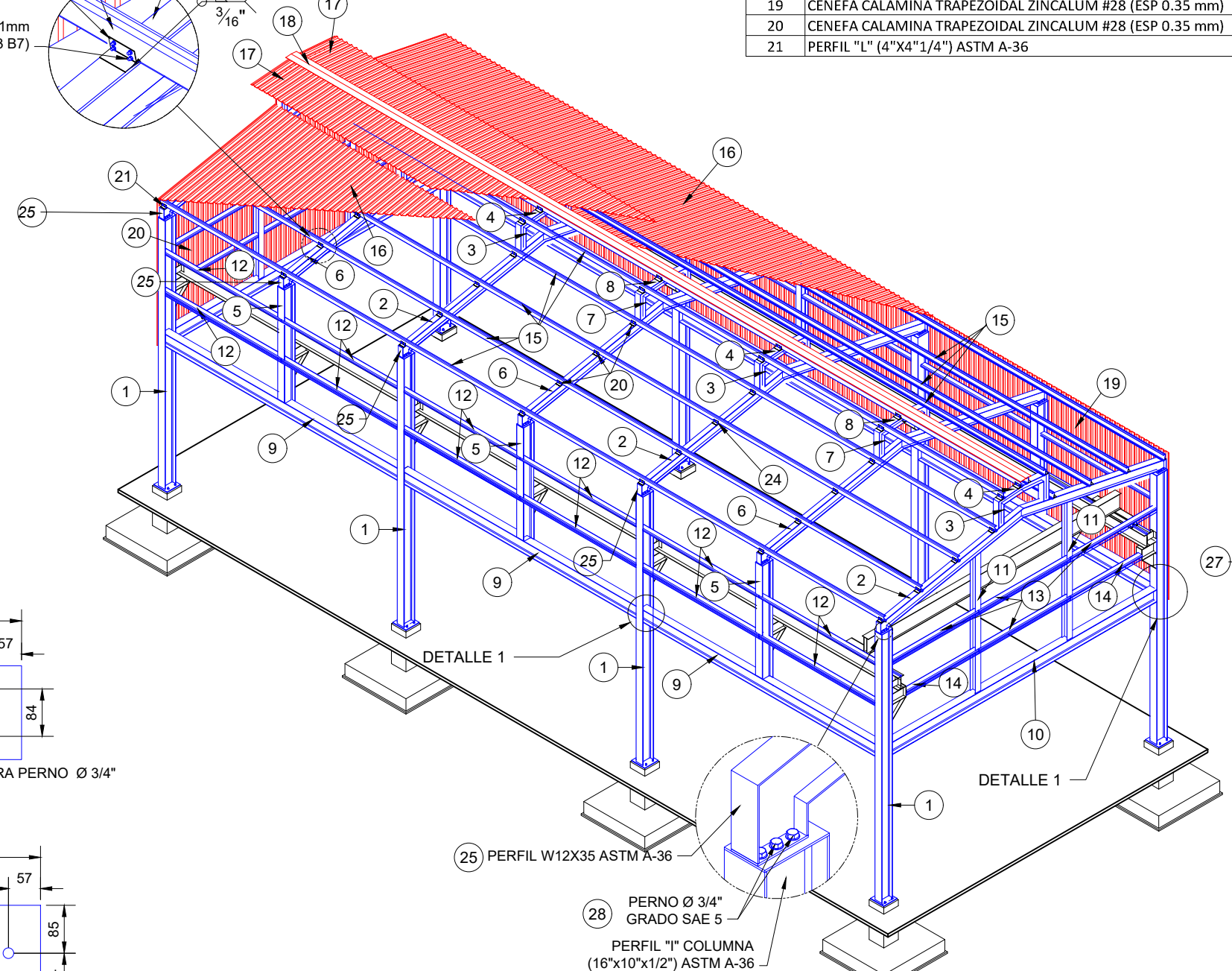

DETALLE 2
S/E

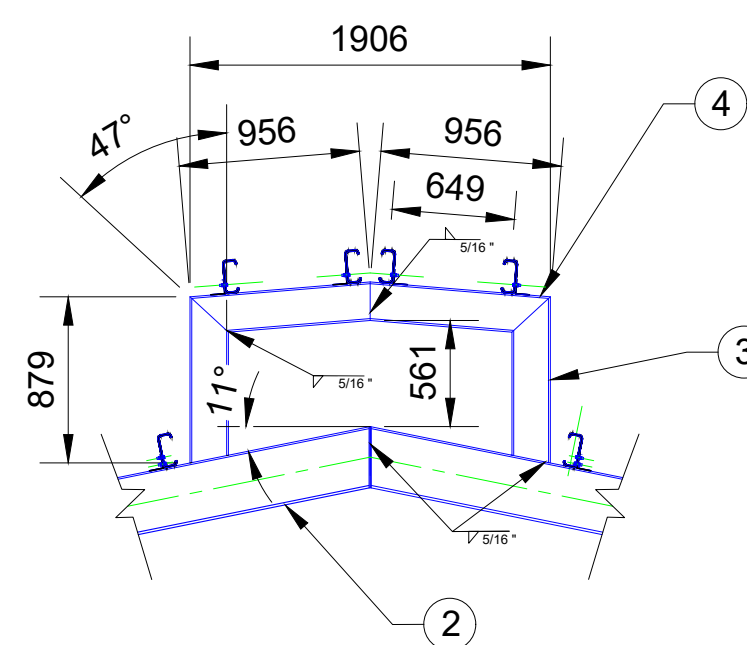

MATERIAL DE PORTICO PRINCIPAL						
CODIGO	MATERIAL	UNIDAD	DIMENSION	PIEZAS	TOTAL	PESO (KG)
1	PERFIL "I" COLUMNA (16"x10"x1/2") ASTM A-36	m	9,132	8	73,056	7388,27
2	PERFIL W12X35 ASTM A-36 (CORDON)	m	5,491	8	43,928	4442,51
3	PERFIL W10X22 ASTM A-36 (CUMBRERA)	m	0,879	8	7,032	325,47
4	PERFIL W10X22 ASTM A-36 (CUMBRERA)	m	0,956	8	7,648	353,98
22	CARTELA SUPERIOR 318x16x12.5mm ASTM A-36	Pza.	-	8	-	-
23	CARTELA INFERIOR 406x254x12.7mm ASTM A-36	Pza.	-	8	-	-
24	PERNOS (1/2") ASTM A-193 B7	Pza.	-	192	-	-
25	PERFIL W12X35 ASTM A-36 (CORDON)	m	0,333	8	2,664	49,07088
26	CARTELA INFERIOR 381x272x12.7mm ASTM A-36	m2	0,1116	8	0,8928	16,44538
27	CARTELA INFERIOR 150x254x12.7mm ASTM A-37	m2	0,1116	8	0,8928	16,44538
28	PERNOS (3/4") ASTM A-193 B8	Pza.	-	48	-	-
MATERIAL DE PORTICO SECUNDARIO						
5	PERFIL "I" COLUMNA (16"x10"x1/2") ASTM A-36	m	4,035	6	24,21	1120,53
6	PERFIL W12X35 ASTM A-36 (CORDON)	m	5,491	6	32,85	1520,42
7	PERFIL W10X22 ASTM A-36 (CUMBRERA)	m	0,879	6	5,274	244,10
8	PERFIL W10X22 ASTM A-36 (CUMBRERA)	m	0,956	6	5,736	265,48
22	CARTELA SUPERIOR 318x16x12.5mm ASTM A-36	Pza.	-	6	-	-
23	CARTELA INFERIOR 406x254x12.7mm ASTM A-36	Pza.	-	6	-	-
24	PERNOS (1/2") ASTM A-193 B7	Pza.	-	72	-	-
28	PERNOS (3/4") ASTM A-193 B8	Pza.	-	36	-	-
MATERIAL DE CUBIERTA - VIGAS DE CERRAMIENTO, CORREAS						
9	PERFIL "I" VIGA DE CERRAMIENTO (16"x10"x1/2") ASTM A-36	m	9,000	6	54,000	5461,10
10	PERFIL "I" VIGA DE CERRAMIENTO (16"x10"x1/2") ASTM A-36	m	10,479	2	20,958	2119,52
11	PERFIL W10X22 (10,17" x 5,75") ASTM A-36 (COLUMNA)	m	4,376	4	17,504	810,15
12	PERFIL "2C" CERRAMIENTO (8"x3"x1/3/16") ASTM A-36	m	4,500	12	54,000	717,87
13	PERFIL "2C" CERRAMIENTO (8"x3"x1/3/16") ASTM A-36	m	3,453	8	20,718	275,42
14	PERFIL "2C" CERRAMIENTO (8"x3"x1/3/16") ASTM A-36	m	2,620	4	10,480	139,32
15	PERFIL "C" CORREA (8"x3"x1/3/16") ASTM A-36	m	27,254	12	327,048	4726,30
16	CALAMINA TRAPEZOIDAL ZINCALUM #28 (ESP 0.35 mm)	m2	311,666	2	623,332	-
17	CALAMINA TRAPEZOIDAL ZINCALUM #28 (ESP 0.35 mm)	m2	103,893	2	207,786	-
18	CUMBRERA CALAMINA TRAPEZOIDAL ZINCALUM #28 (ESP 0.35 mm)	m2	22,349	1	22,349	-
19	CENEFAS CALAMINA TRAPEZOIDAL ZINCALUM #28 (ESP 0.35 mm)	m2	321,428	2	642,856	-
20	CENEFAS CALAMINA TRAPEZOIDAL ZINCALUM #28 (ESP 0.35 mm)	m2	145,129	2	290,258	-
21	PERFIL "L" (4"x4"x1/4") ASTM A-36	m	101,600	84	8534,400	113,29